



SUPER FAST DIODE MODULE TYPE 300A

Features

- High Surge Capability
- Type 600V V_{RRM}
- Isolation Type Package
- Electrically Isolation base plate



Maximum Ratings

Operating Temperature : -55°C to +175°C
 Storage Temperature : -55°C to +175°C

| Part Number | Maximum Recurrent Peak Reverse Voltage | Maximum RMS Voltage | Maximum DC Blocking Voltage |
|--------------|--|---------------------|-----------------------------|
| MURIDA300A60 | 600V | 420V | 600V |

Dimensions in mm (1 mm = 0.0394")

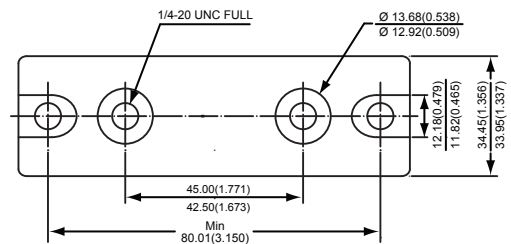

Electrical Characteristics @ 25 °C Unless Otherwise Specified

| | | | |
|--|------------------|--------------------|---|
| Average Forward Current (Per pkg) | $I_{F(AV)}$ | 300A | $T_C = 100^\circ C$ |
| Peak Forward Surge Current | I_{FSM} | 4400A | 8.3ms , half sine |
| Maximum Instantaneous Forward Voltage * | V_F | 1.35V | $I_{FM}=300A$; $T_J = 25^\circ C$ |
| Maximum Instantaneous Reverse Current At Rated DC Blockig Voltage* | I_R | 30 μA 5 mA | $T_J = 25^\circ C$ $T_J = 125^\circ C$ |
| Maximum Reverse Recovery Time | T_{rr} | 200ns | $I_F = 0.5A$, $I_R=1.0A$, $I_{RR}=0.25A$ |
| Isolation Voltage | V_{isol} | 3000 V | A.C. 1minute |
| Maximum Thermal Resistance Junction To Case | $R_{\theta j c}$ | 0.28°C/W | |

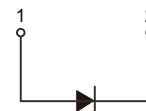
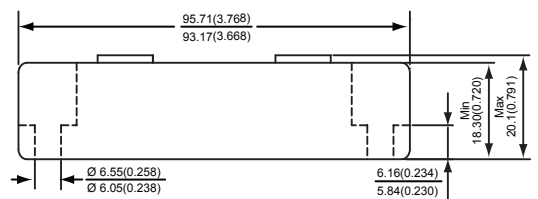

*Pulse Test: Pulse Width 300 μsec , Duty Cycle 2%



Figure .1- Typical Forward Characteristics

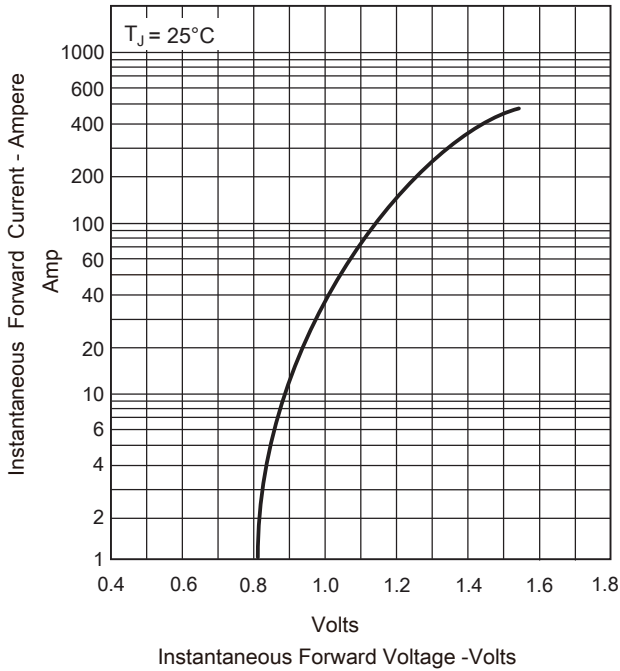

Figure .2-Forward Derating Curve

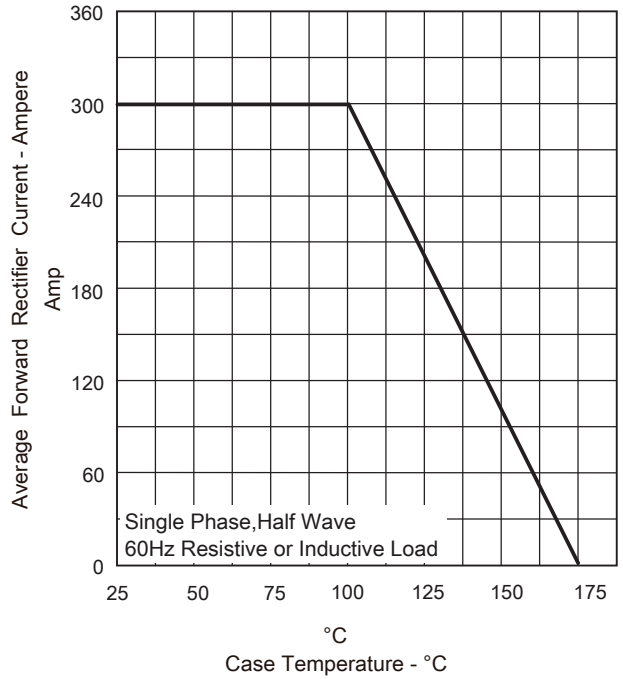

Figure .3- Peak Forward Surge Current

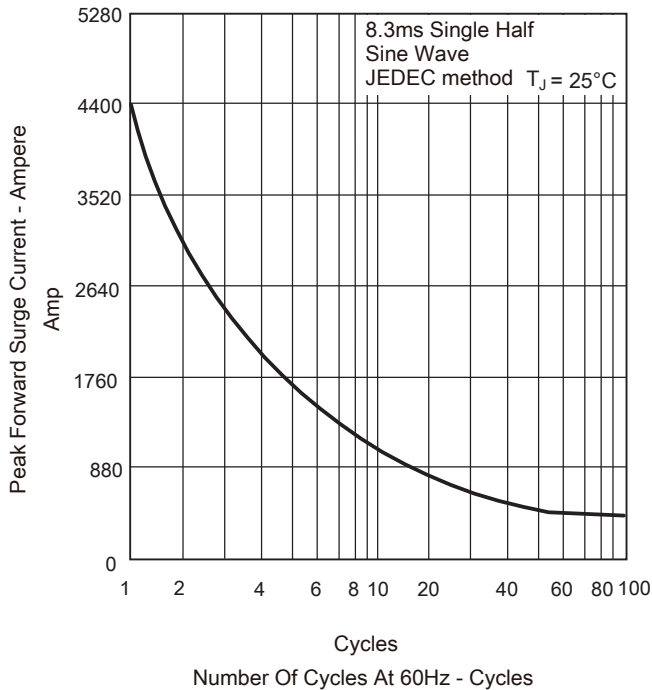

Figure .4 -Typical Reverse Characteristics

