



SUPER FAST DIODE MODULE TYPE 300A

Features

- High Surge Capability
- Type 200V V_{RRM}
- Isolation Type Package
- Electrically Isolation base plate



Maximum Ratings

Operating Temperature : -55°C to +175°C
 Storage Temperature : -55°C to +175°C

Part Number	Maximum Recurrent Peak Reverse Voltage	Maximum RMS Voltage	Maximum DC Blocking Voltage
MURIDA30020	200V	140V	200V

Dimensions in mm (1 mm = 0.0394")

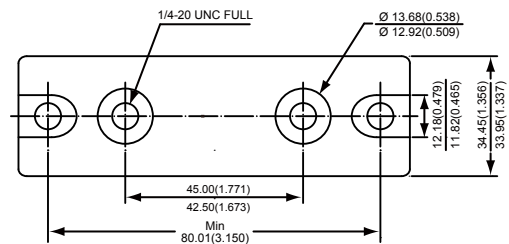

Electrical Characteristics @ 25 °C Unless Otherwise Specified

Average Forward Current (Per pkg)	$I_{F(AV)}$	300A	$T_C = 100^\circ C$
Peak Forward Surge Current	I_{FSM}	4400A	8.3ms , half sine
Maximum Instantaneous Forward Voltage *	V_F	0.95V	$I_{FM}=300A;$ $T_J = 25^\circ C$
Maximum Instantaneous Reverse Current At Rated DC Blockig Voltage*	I_R	30 μA 5 mA	$T_J = 25^\circ C$ $T_J = 125^\circ C$
Maximum Reverse Recovery Time	T_{rr}	235ns	$I_F = 0.5A, I_R=1.0A,$ $I_{RR}=0.25A$
Isolation Voltage	V_{isol}	3000 V	A.C. 1minute
Maximum Thermal Resistance Junction To Case	$R_{\theta j c}$	0.28°C/W	

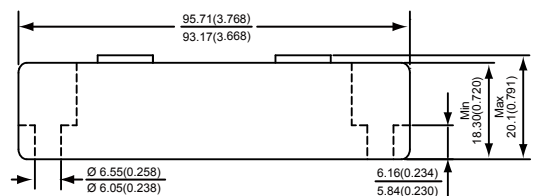

*Pulse Test: Pulse Width 300 μsec , Duty Cycle 2%



Figure .1- Typical Forward Characteristics

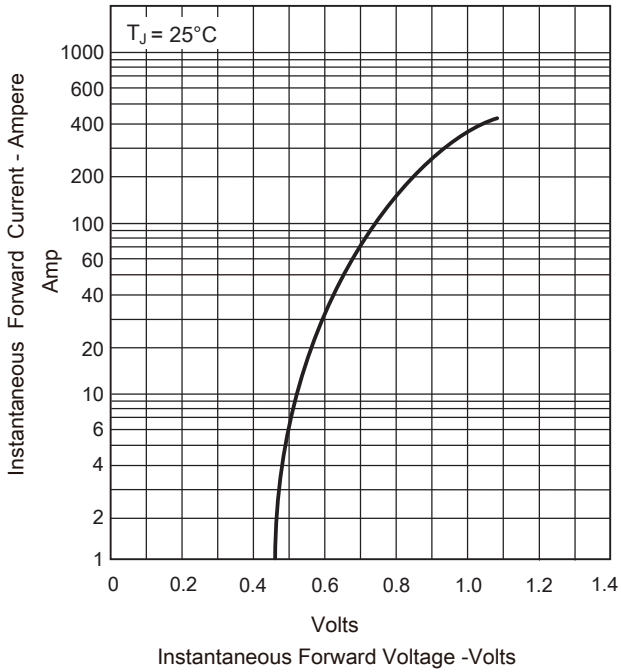

Figure .2-Forward Derating Curve

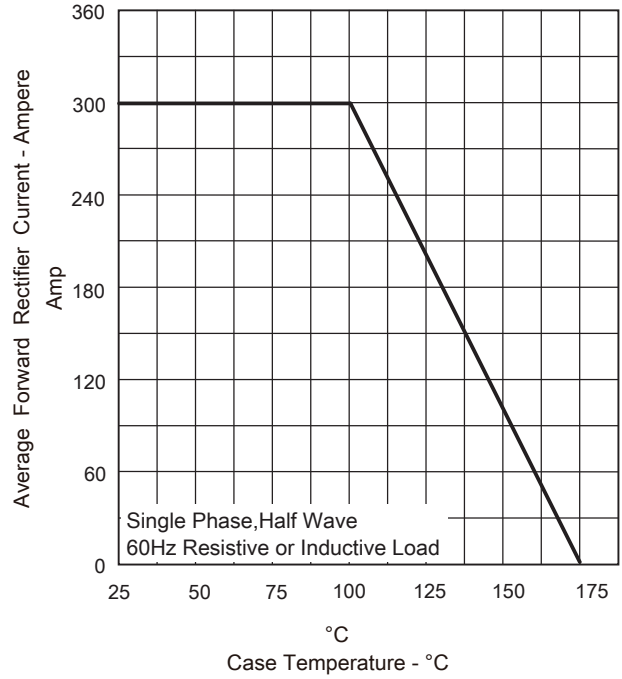

Figure .3- Peak Forward Surge Current

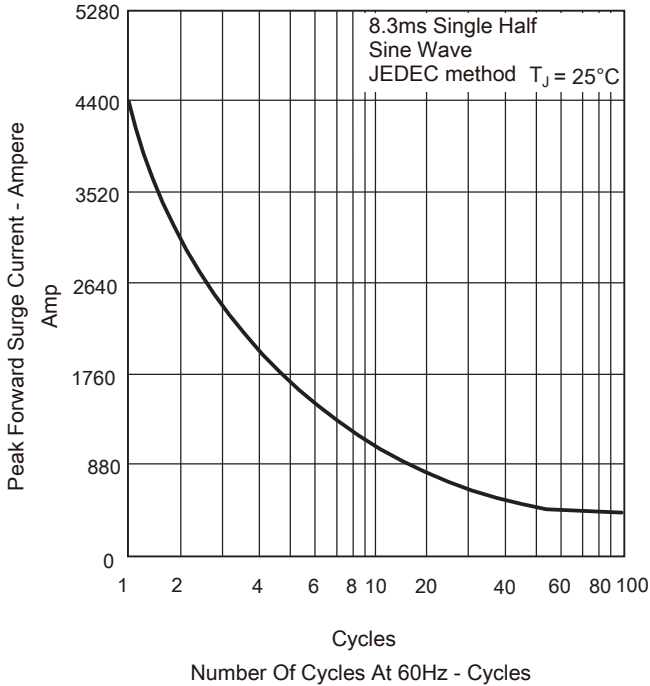

Figure .4-Typical Reverse Characteristics

