



SCHOTTKY DIODE MODULE TYPE 600A

Features

High Surge Capability
Type 200V V_{RRM}



Maximum Ratings

Operating Temperature: -55°C to $+150^{\circ}\text{C}$
Storage Temperature: -55°C to $+150^{\circ}\text{C}$

Part Number	Maximum Recurrent Peak Reverse Voltage	Maximum RMS Voltage	Maximum DC Blocking Voltage
MBRQ601200CT(R)	200V	140V	200V

Dimensions in mm (1 mm = 0.0394")

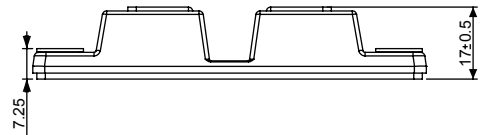

Electrical Characteristics @ 25°C Unless Otherwise Specified

Average Forward Current (Per pkg)	$I_{F(AV)}$	600A	$T_C = 125^{\circ}\text{C}$
Peak Forward Surge Current (Per leg)	I_{FSM}	5200A	8.3ms, half sine
Maximum Instantaneous Forward Voltage (Per leg) NOTE (1)	V_F	0.82V 0.91V	$I_{FM} = 300\text{A}; T_J = 125^{\circ}\text{C}$ $I_{FM} = 300\text{A}; T_J = 25^{\circ}\text{C}$
Maximum Instantaneous Reverse Current At Rated DC Blocking Voltage (Per leg) NOTE (1)	I_R	4mA 10mA 50mA	$T_J = 25^{\circ}\text{C}$ $T_J = 100^{\circ}\text{C}$ $T_J = 150^{\circ}\text{C}$
Maximum Thermal Resistance Junction To Case (Per leg)	$R_{\theta jc}$	0.13 $^{\circ}\text{C}/\text{W}$	
Mounting torque		4 ± 0.5Nm 4 ± 0.5Nm	To heatsink To terminals

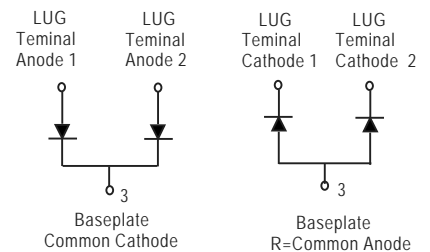
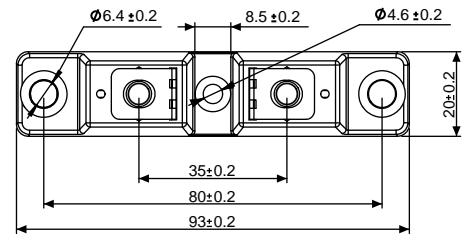

NOTE :

(1) Pulse Test: Pulse Width 300 μ sec. Duty Cycle < 2%



Figure.1 - Typical Forward Characteristics

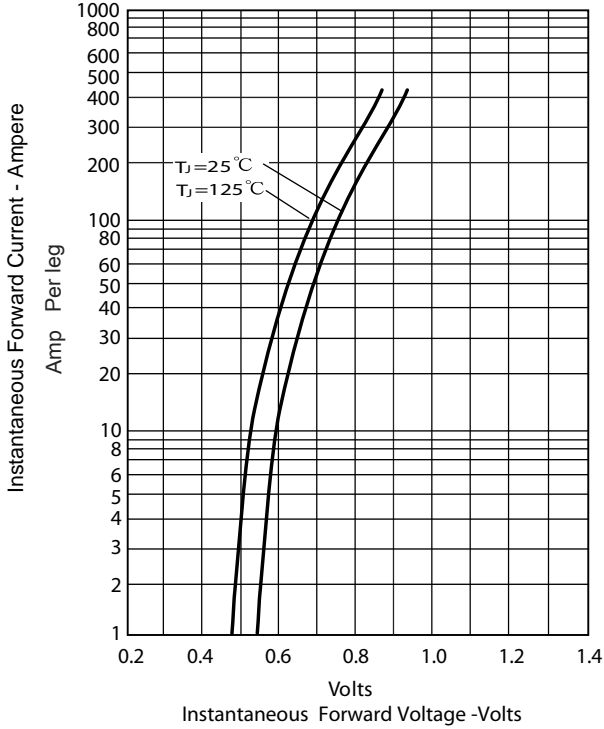

Figure.2 - Forward Derating Curve

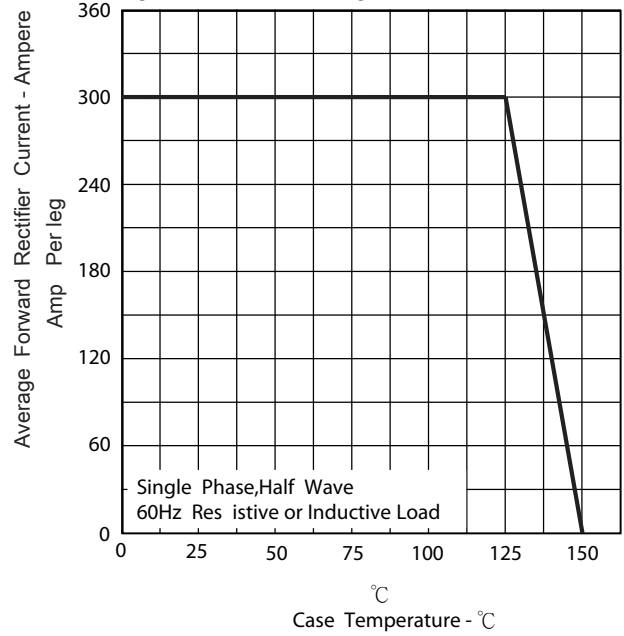

Figure.3 - Peak Forward Surge Current

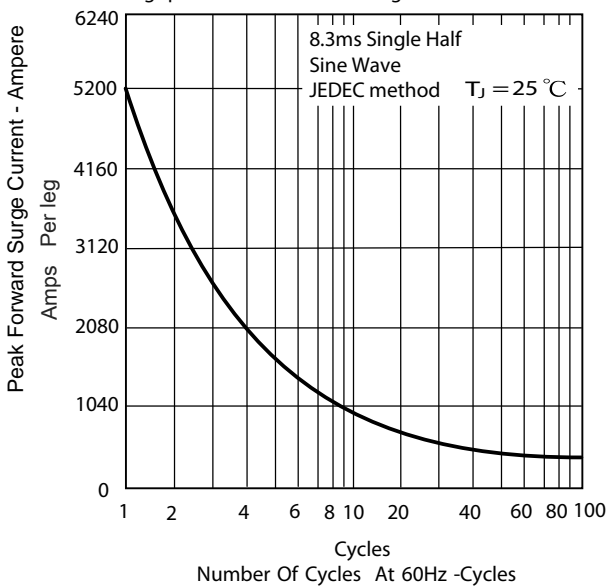

Figure.4 - Typical Reverse Characteristics

