



SCHOTTKY DIODE MODULE TYPE 800A

Features

High surge Capability
Type 200V V_{RRM}



Maximum Ratings

Operating Temperature: -55 °C to +150 °C
Storage Temperature: -55 °C to +150 °C

Dimensions in mm (1 mm = 0.0394")

Part Number	Maximum Recurrent Peak Reverse Voltage	Maximum RMS Voltage	Maximum DC Blocking Voltage
MBRA801200CT(R)	200V	140V	200V

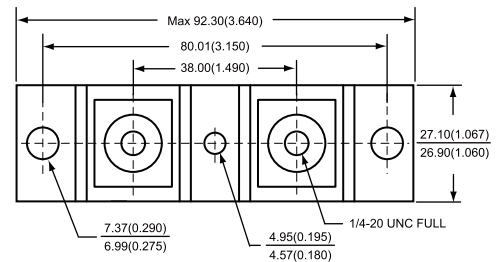

Electrical Characteristics @ 25°C Unless Otherwise Specified

Average Forward Current (Per pkg)	$I_{F(AV)}$	800A	$T_C = 100^\circ\text{C}$
Peak Forward Surge Current (Per leg)	I_{FSM}	6200A	8.3ms , half sine
Maximum Instantaneous Forward Voltage (Per leg)	V_F	0.91V	$I_{FM}=400A; T_J=25^\circ\text{C}$
Maximum Instantaneous Reverse Current At Rated DC Blocking Voltage (Per leg)	I_R	5mA 10mA 80mA	$T_J = 25^\circ\text{C}$ $T_J = 100^\circ\text{C}$ $T_J = 150^\circ\text{C}$
Maximum Thermal Resistance Junction To Case (Per leg)	$R_{\theta jc}$	0.25°C/W	

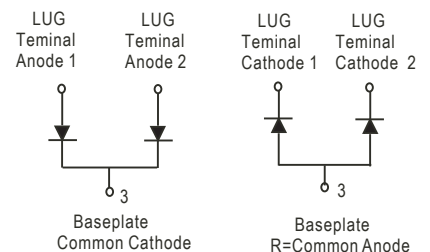
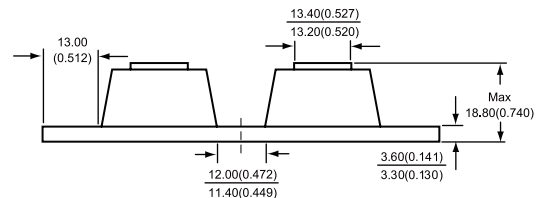

NOTE :

(1) Pulse Test : Pulse Width 300 μ sec , Duty < 2%



Figure.1-Typical Forward Characteristics

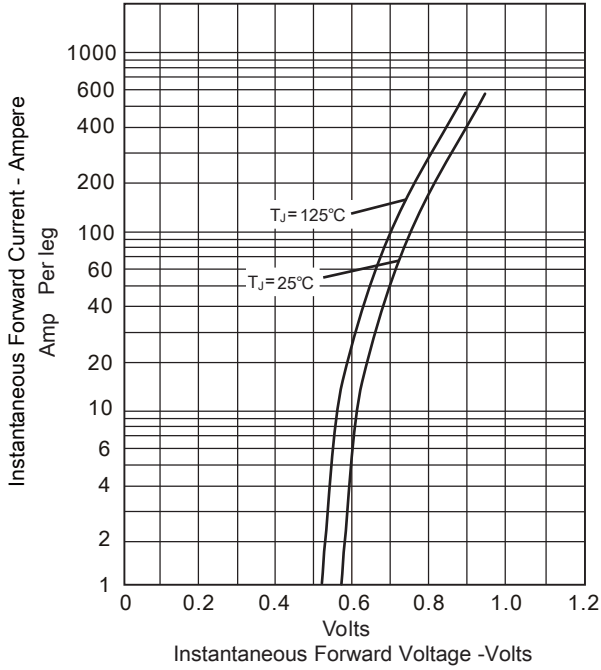

Figure.2-Forward Derating Curve

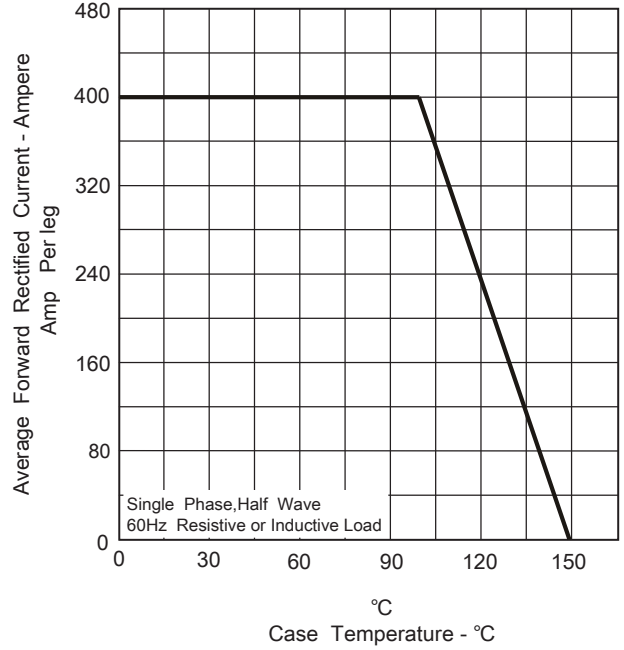

Figure.3-Peak Forward Surge Current

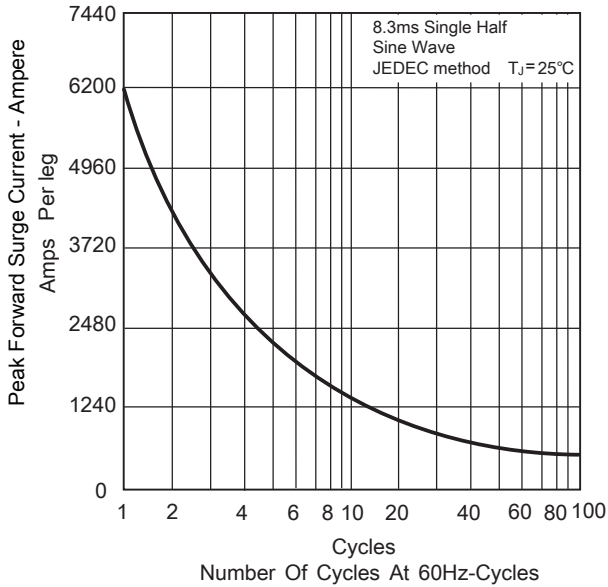

Figure.4-Typical Reverse Characteristics

